

COVID-19 SAFETY UPDATES AND PROTOCOLS

2021 SILICON VALLEY OPEN

As of 08/04/21

MASK POLICY –

Masks are required to be worn indoors by ALL people (including fully vaccinated people) in keeping with the latest orders issued by the Santa Clara Public Health Department, U.S. Figure Skating, and Solar4America Ice. The ONLY exception to this rule is for skaters who may remove their masks when they are on the ice alone while competing. Masks must be put back on immediately upon leaving the ice.

All persons entering the rink must comply with these requirements or be subject to being asked to leave the premises.

HEALTH SCREENING –

We will no longer be doing temperature checks and health screening as a pre-requisite to enter the building. However, by entering the building you are confirming that you have NOT experienced these symptoms within the last 10 days (NOT attributed to another health condition): Shortness of breath, difficulty breathing, cough, fever, headache, chills, sore throat, loss of taste or smell, body aches, nasal congestion, runny nose, diarrhea, or fatigue. If you have any of these symptoms, please exercise caution and DO NOT come to the rink. If you have been in close contact in the last 14 days with someone diagnosed with Covid-19, currently awaiting results from a recent Covid-19 test or had a positive Covid-19 test in the past 10 days, please contact Medical Personnel before deciding to come to the rink.

REGISTRATION and WARM-UP AREA

Please do not come to the Registration Desk earlier than one hour before your event to pick up credentials for yourself and/or your coach. You may proceed to the Warm-up area with your coach if you are warming up inside or if you do not want to wear a mask you must warm up outside the rink. Please proceed to the skate prep area (in the lobby in front of the snack bar) to put on your skates approximately 15 minutes before your event. Please refer to the attached map to locate the Warm-Up area and Skate Prep areas.

LOCKER ROOMS –

No locker rooms are available for changing at this event and restrooms should not be used as changing areas. Please arrive in your costume ready to skate.

COACHES –

Each athlete is allowed one coach to accompany them to the warm-up area, skate prep area and rink side during the competition. Coaches and athletes should exit the building as soon as possible after their event.

SPECTATORS –

While we are no longer limiting the number of spectators per skater, all Spectators must go to the seating area on the 2nd level as soon as they enter the building to wait until their skater's event is completed. After

the event is completed, please proceed outside the building to wait for your skater. We ask that each skater's spectator group sit together and observe appropriate social distancing from others in the seating area.

SKATING RESULTS AND AWARDS -

All results will be posted on-line as soon as possible after the completion of the event. You can find results here:

<https://ijs.usfigureskating.org/leaderboard/results/2021/30003/index.asp>.

Skaters may re-enter the rink after their results are posted to pick up their award from the Registration Desk.

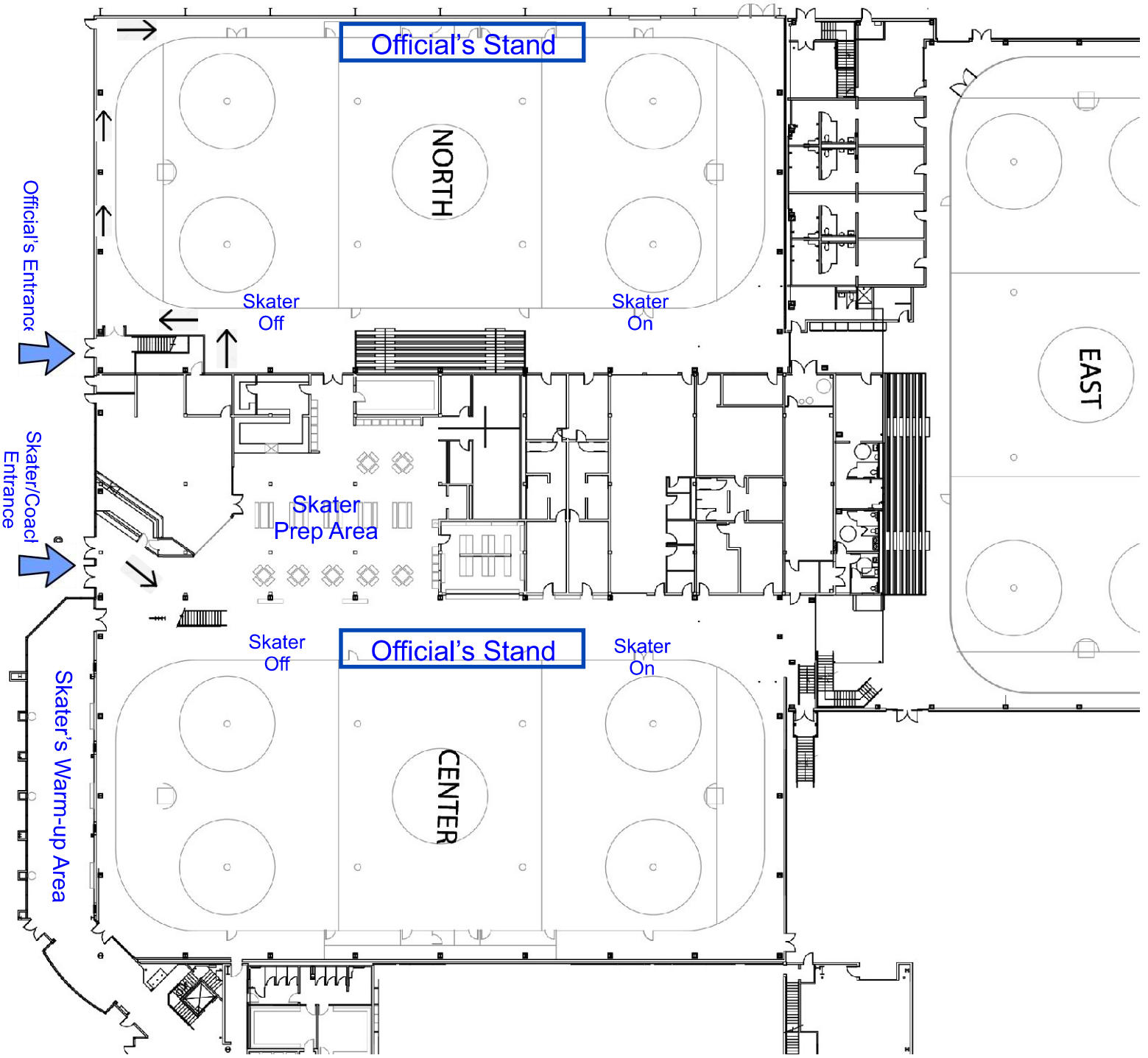

Sharks Ice at San Jose
(First Floor)
1500 South Tenth Street
San Jose, California

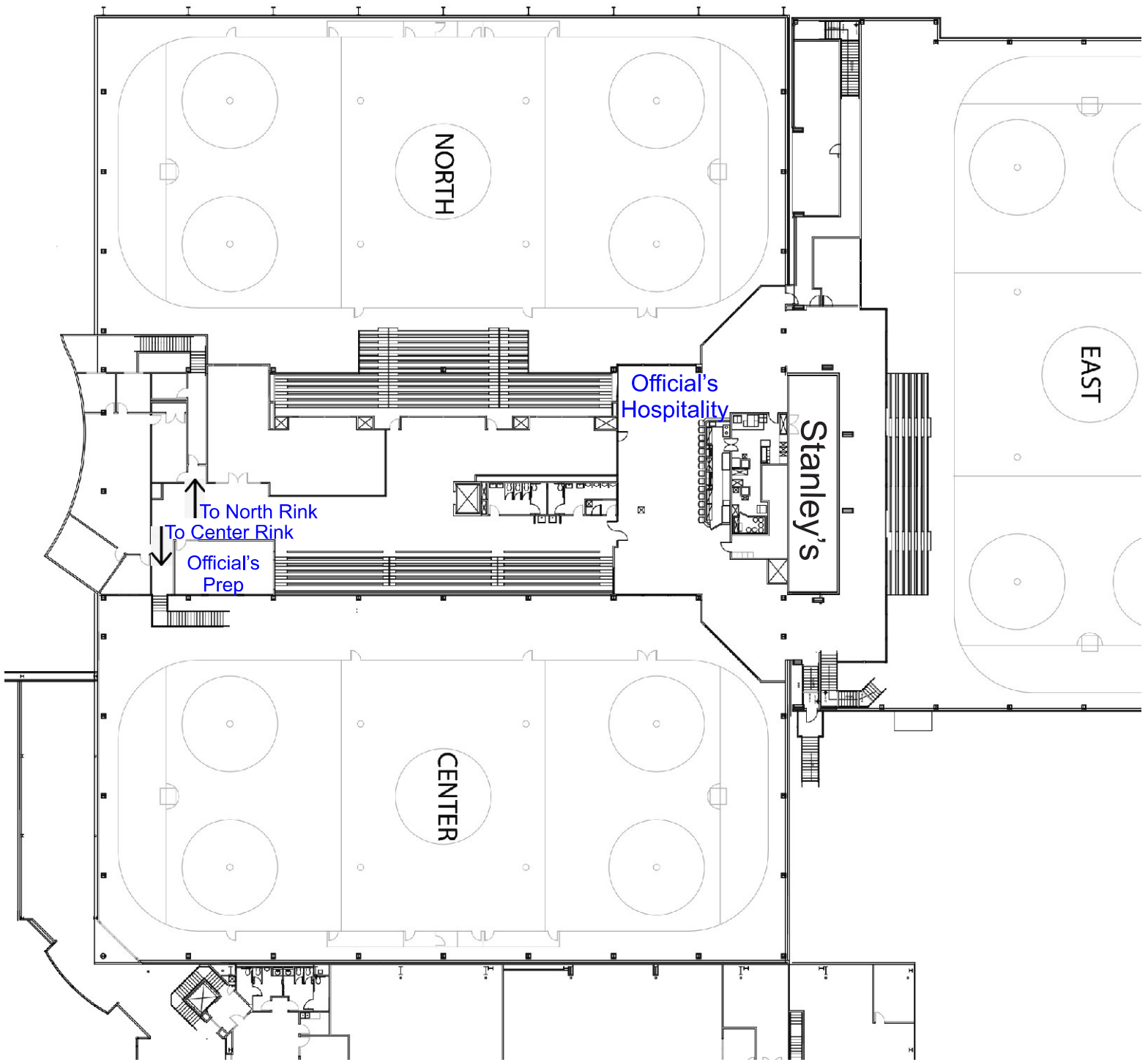

Sharks Ice at San Jose
(Second Floor)
1500 South Tenth Street
San Jose, California