



# 2024 NATIONAL SHOWCASE KNOW BEFORE YOU GO!

San Jose, CA

August 5-10, 2024

## TABLE OF CONTENT

(items are hyperlinked)

1. [Introduction](#)
2. [Registration](#)
3. [Ice Check-In](#)
4. [Props](#)
5. [Ticket and Pin Sales](#)
6. [Practice Ice Purchases](#)
7. [Team Music in the Grey Rink](#)
8. [Rink Diagram](#)

## 9. Exploring San Jose

## Welcome!

Home of the NHL's San Jose Sharks and the AHL's San Jose Barracudas, Sharks Ice San Jose is the largest rink facility west of the Mississippi. We are one of only seven rink facilities in the United States that currently operates at least six NHL-sized ice rinks. A massive 370,000 square feet, it also features a pro shop, a full-service restaurant, and bar. Solar4America Sharks Ice San Jose is located at 1500 South Tenth Street, San Jose, California 95112 at the corner of South Tenth Street and Alma Ave. Click [here](#) for parking options.

Schedules, starting orders, results, video & photo information, ticket purchasing, and volunteer opportunities can be found on our website:

<https://www.peninsulaskatingclub.org/competitions>

Starting Orders and Results:

<https://ijs.usfigureskating.org/leaderboard/results/2024/35479/index.asp>



The facility houses six ice surfaces and we are using three of them: the Orange rink, the Black rink, and the Grey rink (practice only). We are using the main entrance. The entrance will be marked with the Peninsula Skating Club sign. Upon entry if you turn left and go through the glass doors, you will find the registration desk, ticket and practice ice sales, tables for photography and video, the apparel vendor with logo apparel available for purchase, and an engraver. The award podium will also be in the lobby. Awards can be picked up at the registration desk and the podium used for pictures.

In both rinks, the judges, music & announcing, videographer, and photographer will be located on the same side as the bleachers/spectator viewing areas.

### IMPORTANT INFORMATION

- Once competition starts, traffic will heavily increase. Be prepared and allow for extra time to get to the facility.
- Limited parking at the facility, but paid parking is available across the street at the San Jose State parking garage.

## CREDENTIALS

- Every skater and primary coach will be issued an event credential for identification and to provide access to appropriate areas.
- The credential must be visible at all times.
- The following violations are grounds for IMMEDIATE revocation of your credential:
  - Loaning or giving your credential to someone else
  - Entering secure areas in which you are not authorized

## REGISTRATION, CREDENTIALS, AWARDS, TICKET, PIN, AND PRACTICE ICE SALES

### Times are subject to change

- |                                     |                   |
|-------------------------------------|-------------------|
| • Monday, August 5 <sup>th</sup>    | 6:00 am -8:30 pm  |
| • Tuesday, August 6 <sup>th</sup>   | 6:00 am - 8:30 pm |
| • Wednesday, August 7 <sup>th</sup> | 6:00 am - 8:30 pm |
| • Thursday, August 8 <sup>th</sup>  | 6:00 am - 8:30 pm |
| • Friday, August 9 <sup>th</sup>    | 6:00 am - 8:30 pm |
| • Saturday, August 10 <sup>th</sup> | 6:00 am - 5:00 pm |

- ***All skaters are to check in with the ice monitor 15 minutes before spotlight practices and competition events. Skaters skate in the order listed on the practice ice sheets.***
- ***For spotlight practices, upon check-in 15 minutes prior to the beginning of the session, skaters are to identify to the ice monitor, the program that will be skated. For example, “I will be performing my Character Performance – Preliminary program.”*** For more information, go to the “Ice Check-Ins” Section
- ***All awards for events posted after the awards desk closes may be picked up the next day.***
- ***Locker room availability will be posted at registration.***

## Registration

Five separate stations will be set up: 1) Volunteer Check-In, 2) Singles with last names A-K and 3) Singles last names L-Z, 4) Teams and 5) Coaches. Check-in at the correct station.

### Station 1: Volunteer Check-In

Please volunteer!



Once a volunteer completes two three hour shifts, she/he is eligible for a day pass of her/his choosing. The lead verifies the two shifts by putting check marks next to them in the volunteer check-in book and writes out a receipt with the volunteer's name and requested day pass that is then redeemed at the Ticket Sales desk.

### Stations 2 and 3: Skater Check-In

Two binders, separated alphabetically A-K and L-Z, contain all of the registered skaters' names. Skaters are to check-in, receive their credentials, and National Showcase slingbag gifts.

### Station 4:

There are 142 teams that include duets/trios, inflatables, mini-productions, and production teams. They are required to check in. Either the team manager or coach checks the team in.

### Station 5: Coaches

This station contains a list of all coaches designated as primary coaches. Only coaches listed as primary receive credentials. **If they are not on the list, they DO NOT receive credentials.** If they have not been pre-approved by us, they are also required to show USFS coach compliance by displaying compliance cards either on their phones or printed copies. They are to go into their USFS Members Only profiles and click on Compliance Card. **Credentials will not be handed out without compliance.**

## Ice Check-ins

Orange and Black: two ice monitors are required at all times.

IM #1: Near the ice entrance, IM #1 checks the skaters in. Upon check-in, the skater tells the ice monitor which event and level, (for instance character – preliminary), they will be skating which is communicated via talkie walkie to the music person.

IM #2 manages the skaters as they come on and off the ice. Props are stored to the right of the ice entrance and IM #2 allows no more than four skaters at a time behind the partition to warm up. When one skater finishes her/his program, the next skater should be on the ice, ready to go

with her/his props. Coaches are to help with this. Skaters enter and exit in the same location – by the door.

**Grey:** There are only 20 minute open sessions on the Grey rink. The houselights are on and there is no music.

## Props

Given the extraordinary number of starts, we anticipate an extraordinary number of props so we require that they **ONLY** be on site on the day of performance. They may be brought in the morning and removed upon event completion, using the rink prop storage area until event time. Please see the rink diagram for its location.

For **Orange** rink events, props are NOT to be brought through the Black rink. After exiting through the glass sliding doors from the prop storage area into the Black rink, turn left and go through the main lobby by the White rink and then into the Orange rink. Props may be temporarily stored in the far left corner of the Orange rink. Signage will help with directions.

For **Black** rink events, props may be brought in quietly between programs.

## Ticket and Pin Sales

All tickets and pins are purchased through Zeffy:



The volunteer will have a list of all purchases and items are redeemed here. If the purchase is made after the list is printed, the purchaser shows the emailed receipt as proof of payment.

## Practice Ice (PI) Purchase

Online sales closes Aug 3 and after that, the purchase of practice is only done on-site at the PI desk. In order to buy PI, the only payment methods accepted are check or the club PayPal account:



In the PayPal comment section, the purchaser must state "NS Practice Ice." The PI sales desk fills out a receipt with the name of the skater, rink, day, and time of session purchased that the skater then presents to the ice monitor.

## **Playing Music in the Grey Rink for Teams**

There are two ways to play music in the Grey rink:

- 1) Connect to the rink system using a male to male auxiliary cable that will be provided by the LOC. A connector, or dongle, will be required to connect from the aux cable to your phone. Different dongles are required for androids and iPhone. To buy, search for dongle adapters.
- 2) Use a portable speaker: if you do not have an auxiliary dongle adapter, bring a portable speaker that connects to the music loaded on your phone.

# Facility Diagram

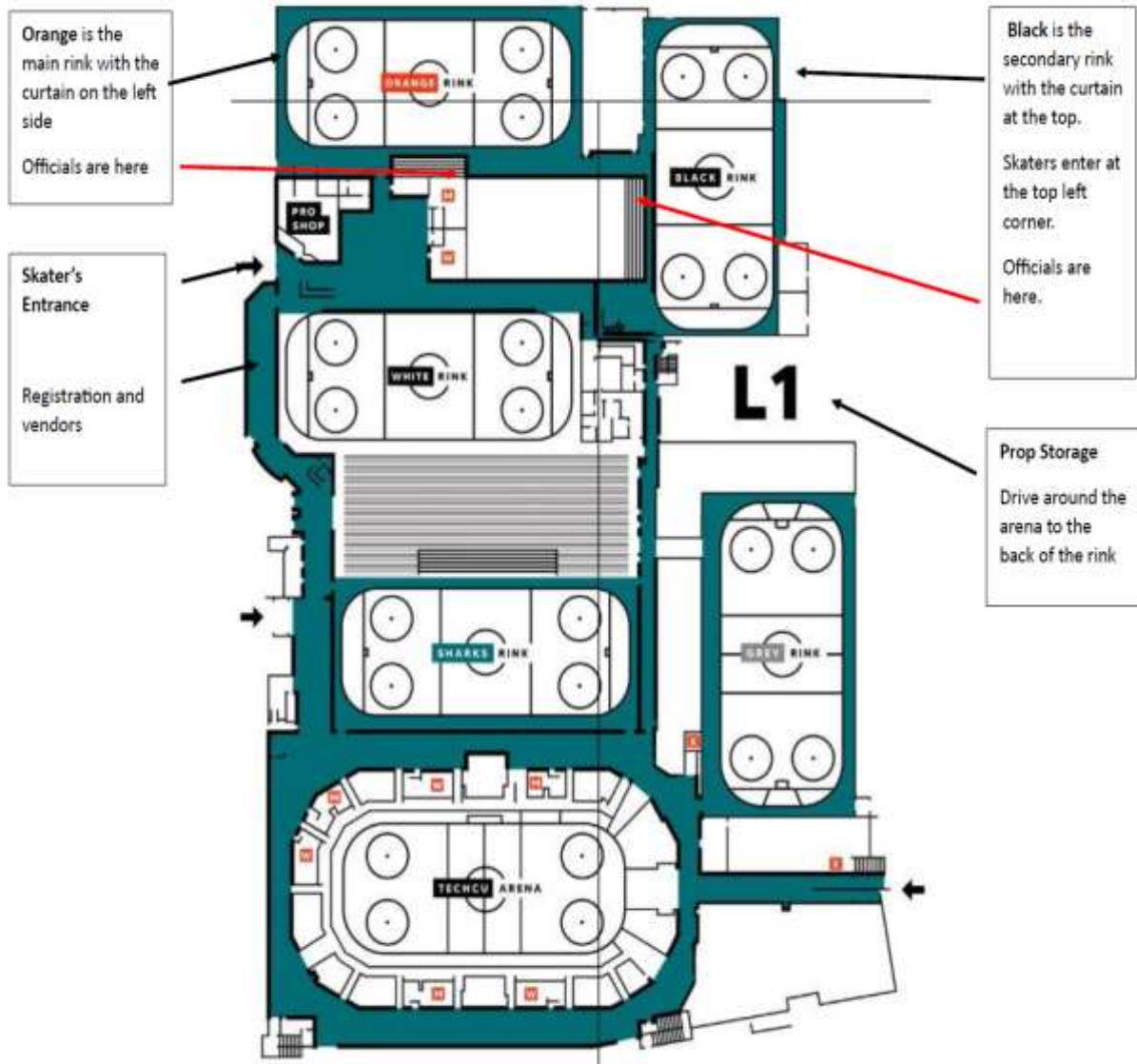

The Scoop on San Jose



Located at the southern end of the San Francisco Bay, in the heart of Silicon Valley (home of 6,000 technology companies), San Jose offers easy access to three major airports and features beautiful scenery; a small, walkable downtown; plenty of fun things to see and do; and a kaleidoscope of restaurants featuring authentic international dishes.

Keep in mind that the sun shines here an average of 300 days a year — it's so bright ya gotta wear shades! August is pleasantly warm, with an average high of 82 degrees.

Here are just some of the many popular attractions in this marvelous city: (*Photos courtesy of [Visit San Jose](#)*)



**Santana Row** — A fun dining and shopping destination, serving up 50 unique shops and restaurants, a movie theater and live entertainment.



**Winchester Mystery House** — One of the largest Victorian homes in the United States, the 160-room mansion boasts odd and mysterious features, such as staircases that lead to the ceiling and doors that open to nowhere. It's been featured on "Mythbusters," "Ghost Adventures" and "Ghost Brothers."

**The Tech Interactive** — A Silicon Valley landmark in the heart of San Jose, this family-friendly science and technology center offers hands-on activities, experimental labs and design challenge experiences. Its goal is to "inspire the innovator in everyone."

[Rosicrucian Egyptian Museum](#) — Home to the largest collection of ancient Egyptian artifacts in the western United States!



[San Pedro Square Market](#) — A lively public market offering an assortment of food from around the world. Visitors can dine in open-air plazas, sidewalk cafes and in three indoor food halls.

[Cathedral Basilica of St. Joseph](#) — Build in 1876, this stunning architectural masterpiece showcases striking stained glass windows.

[San Jose Museum of Art](#) — A must-see for art lovers!

Other family-centric hotspots include [Happy Hollow Park and Zoo](#), the [Children's Discovery Museum of San Jose](#) and [Legoland Discovery Center](#) in Milpitas. What's more, [Santa Cruz](#), [San Francisco](#) and [Half Moon Bay](#) are just a short drive away and offer endless adventure.